

正弦规

651系列

- ◆ 符合JJG正弦规国家计量检定规程，精度0级
- ◆ 合金工具钢



651-004-01H

前后端面及两侧面均可安装靠板

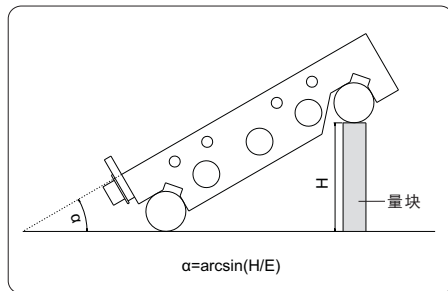
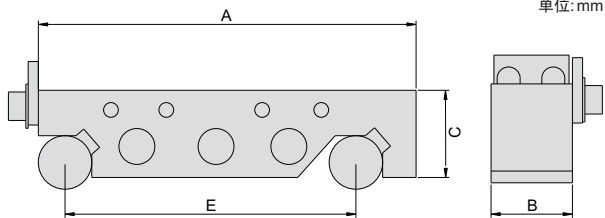
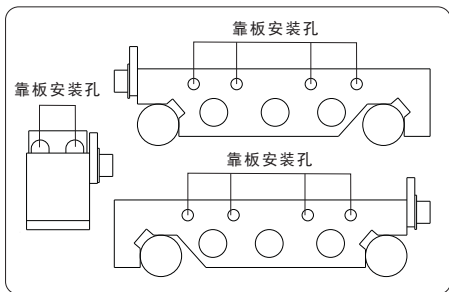

货号	中心距(E)	工作台尺寸(AxB)	精度($\alpha = 30^\circ$)	C
651-004-01H	100mm	130x30mm	$\pm 5''$	40mm
651-008-01H	200mm	230x30mm	$\pm 5''$	40mm
651-012-01H	300mm	345x40mm	$\pm 8''$	50mm

