

单位: mm

- ◆ 符合JB/T曲轴量表国家机械行业标准
- ◆ 用于测量曲轴的变形量
- ◆ 平衡块安装在表后盖上可保持百分表面朝上, 便于读数

测厚表

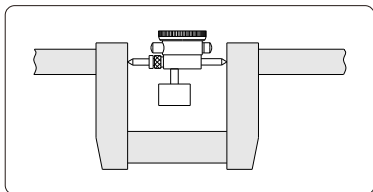

298-012-11

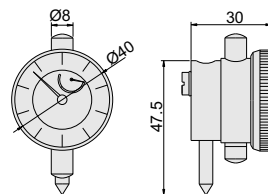

表头

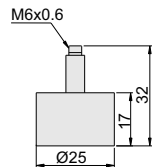

平衡块

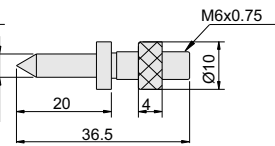
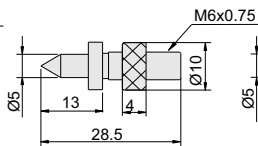
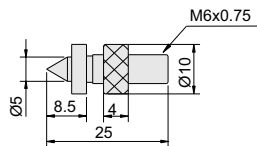

测砧

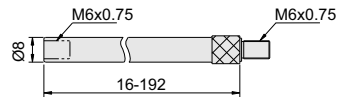

延长杆

| 货号 | 量程 | 表头量程 | 分度值 | 精度 | 延长杆 |
|------------|----------|------|--------|----------|--------------------------------------|
| 298-012-11 | 60-300mm | 3mm | 0.01mm | ±0.016mm | 16mm, 32mm, 64mm, 128mm |
| 298-020-11 | 60-500mm | 3mm | 0.01mm | ±0.016mm | 16mm, 32mm, 64mm, 96mm, 128mm, 192mm |